

Millimetres
100
10
0
DO NOT SCALE

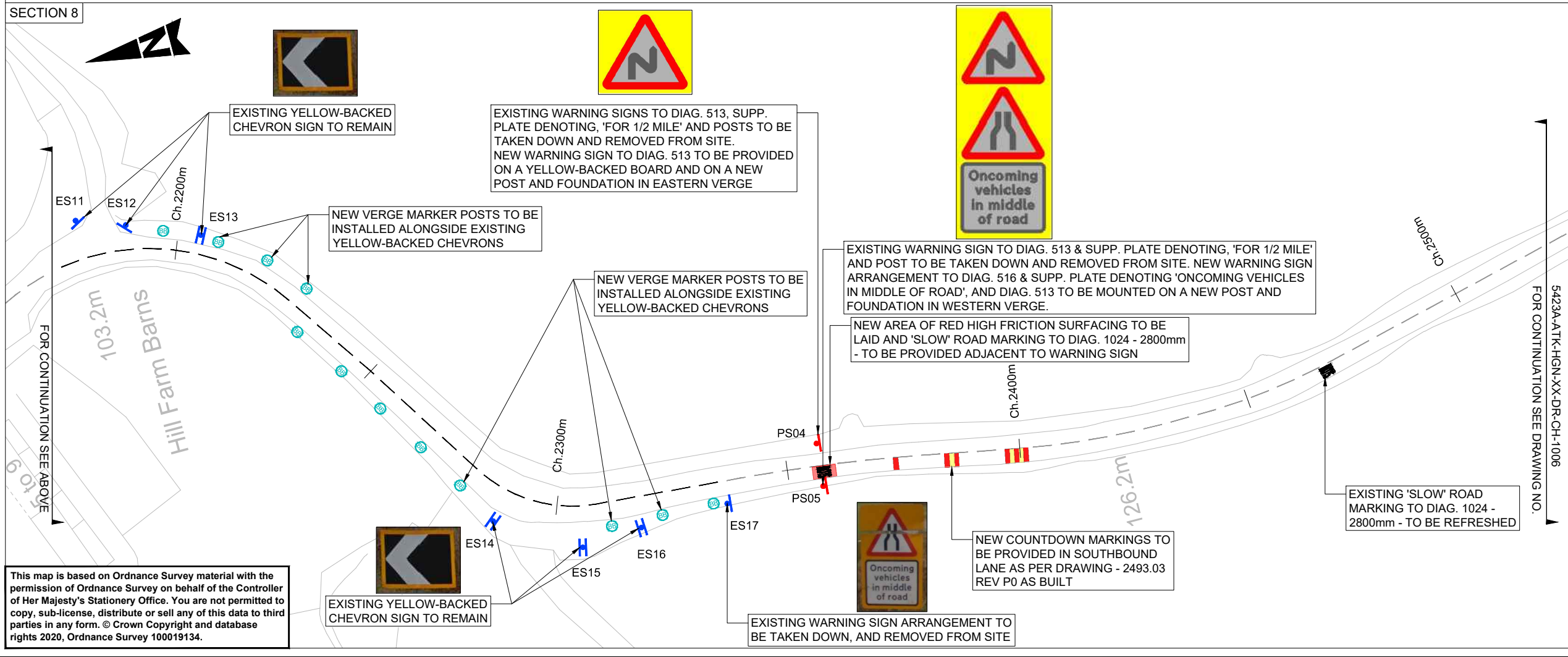
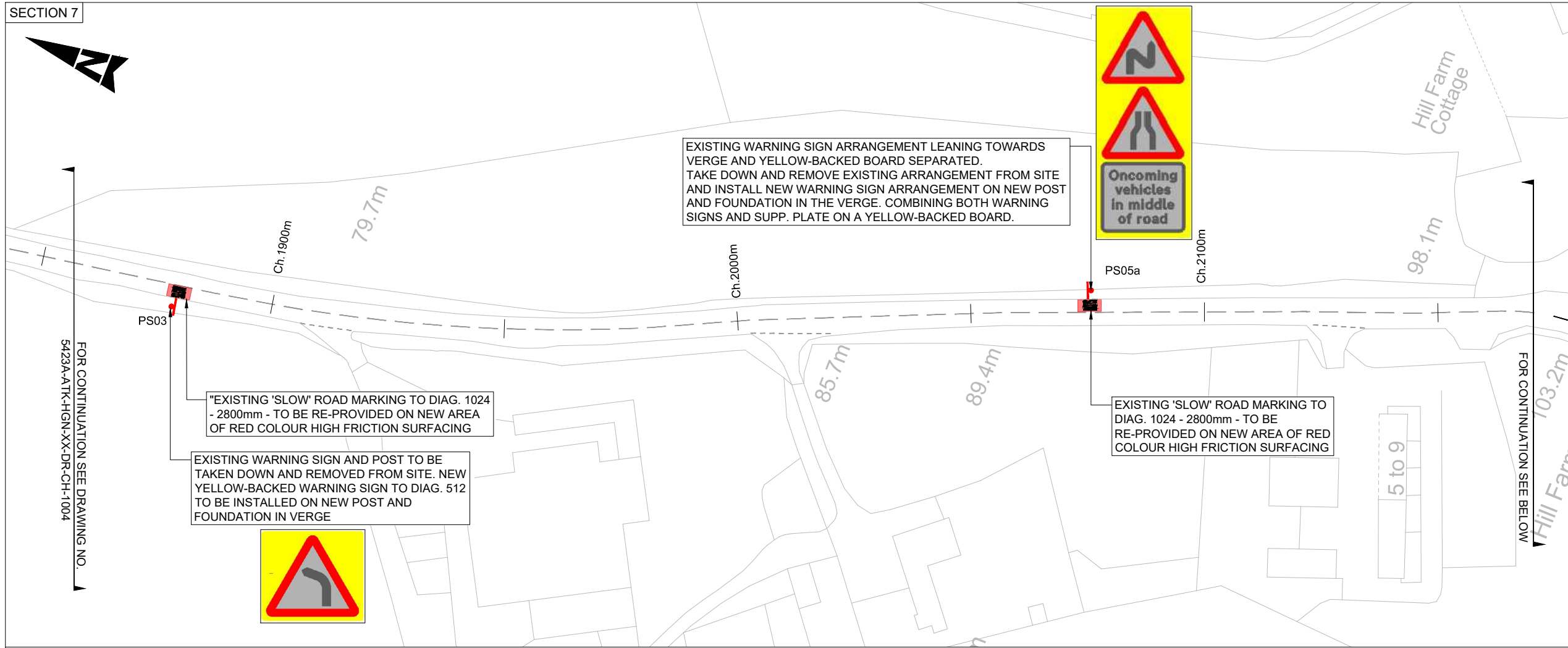

This map is based on Ordnance Survey material with the permission of Ordnance Survey on behalf of the Controller of Her Majesty's Stationery Office. You are not permitted to copy, sub-license, distribute or sell any of this data to third parties in any form. © Crown Copyright and database rights 2020, Ordnance Survey 100019134.

SAFETY, HEALTH AND ENVIRONMENTAL INFORMATION

In addition to the hazards/risks normally associated with the types of work detailed on this drawing, note the following significant residual risks (Reference shall also be made to the design hazard log).

Construction

Maintenance / Cleaning

Use

Decommissioning / Demolition

NOTES:

1. ALL DIMENSIONS ARE IN METRES UNLESS OTHERWISE STATED.

KEY:

- EXISTING ROAD MARKING TO REMAIN
- EXISTING ROAD MARKING TO BE REFRESHED
- PROPOSED HIGH FRICTION SURFACE
- PROPOSED SIGN
- EXISTING SIGN
- PROPOSED VERGE MARKER POST
- COUNTDOWN MARKINGS

Description	Status	Revision	Drawn	Checked	Reviewed	Authorised	Issue Date
FOR CONSTRUCTION	A3	CD1.1	PK	AO	SP	SP	25/07/22
FOR INFORMATION	S2	PD1.1	PK	AO	TL	SP	16/05/22

SNC-LAVALIN
ATKINS

Member of the SNC-Lavalin Group
Copyright © SNC Lavalin (2020) www.atkinsglobal.com

5th Floor, Block 5
Shire Hall
Bearland
Gloucester
GL1 2TH
Tel: 08000 514514

Gloucestershire
COUNTY COUNCIL

Client: Frocester Hill and B4066 Junction

Project Title: Frocester Hill and B4066 Junction

Drawing Title: GENERAL ARRANGEMENT CHAINAGE 1850 TO 2520 (SHEET 4 OF 6)

Project	Originator	Volume	
5423A	ATK	HGN	
XX	DR	CH	
		1005	
Location	Type	Role	Number
A3	Scale: 1:1000	Project Ref: 5213652	Sheet: 4 of 6
			Rev: C01.1